

EU Declaration of Compliance (DOC)

For materials intended to come into contact with food (EU No. 10/2011)

Company name: **Mid Ocean Brands BV (MOB)**
 Postal address: **PO BOX 644**
 Postcode and City: **6710 BP Ede (NL)**
 Telephone number: **0031 (0)342 426992**
 E-mail address: **DOC@reclamond.com**

We declare that DOC issued under our sole responsibility and belongs to the following product:

Item number	MO2470
Description	Water bottle in RPET with removable fruit infuser with carrying handle and leak proof lid. Capacity 500 ml.
Country of origin	China
Batch	PO41-115673

Object of the declaration (identification of food contact product allowing traceability; it may include a colour image of sufficient clarity where necessary for the identification of the product):

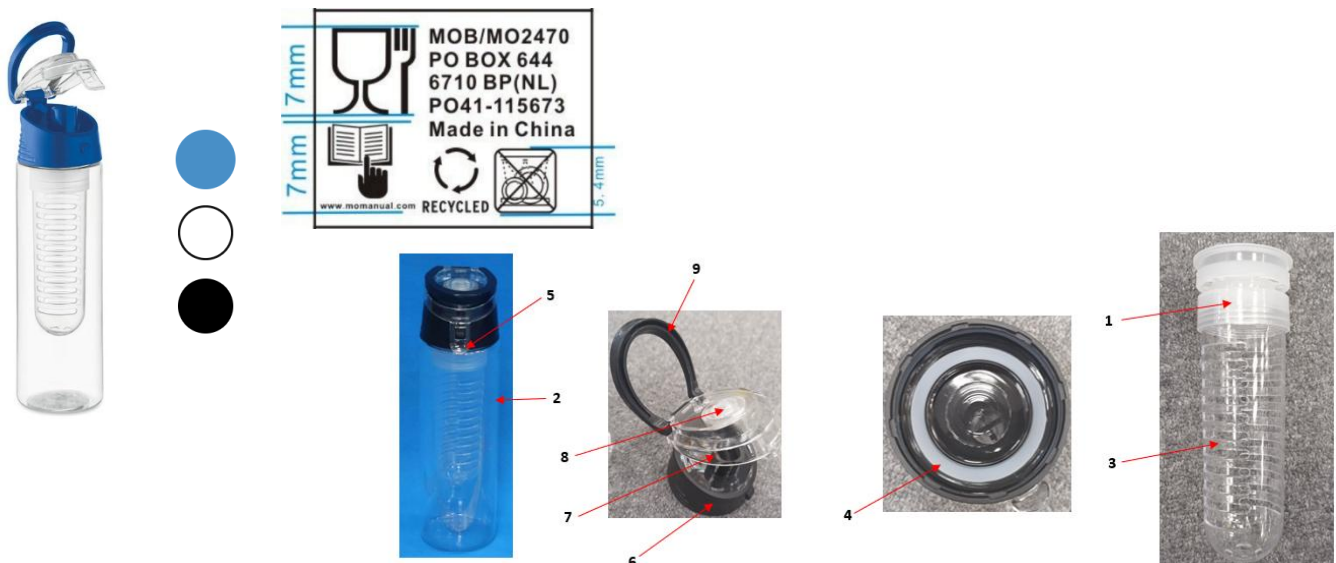

1, 2, 3, 4, 5 : direct food contact

The following substances subject to restrictions and/or specification are used in the above-mentioned product. The materials and raw materials used comply with Regulation (EU) No 10/2011.

Part	Chemical Name	CAS	EINECS	Percent
2	Recycled Polyethylene Terephthalate (RPET)	25038-59-9	607-507-1	44.30%
6	Polypropylene (PP)	9003-07-0	618-352-4	15.80%
3	Polystyrene (PS)	9003-53-6	929-203-0	12.70%
7	Polystyrene (PS)	9003-53-6	929-203-0	9.00%
1	Polypropylene (PP)	9003-07-0	618-352-4	8.20%
9	Polypropylene (PP)	9003-07-0	618-352-4	5.00%
5	Polystyrene (PS)	9003-53-6	929-203-0	2.40%
4	Silicone	7440-21-3	231-130-8	2.00%
8	Silicone	7440-21-3	231-130-8	0.60%

The following substances and materials are intended to come into contact with food.

Chemical Name	CAS	EINECS
Recycled Polyethylene Terephthalate (RPET)	25038-59-9	607-507-1
Polypropylene (PP)	9003-07-0	618-352-4
Polystyrene (PS)	9003-53-6	929-203-0
Silicone	7440-21-3	231-130-8



COMPLIANCE

The manufacturer declares that the mentioned product complies with all relevant provisions of

Regulation (EC) No 1935/2004 - Materials and articles intended to come into contact with food*

Regulation (EU) No 10/2011 - Plastic materials and articles intended to come into contact with food*

Regulation (EC) No 2023/2006 - GMP for materials and articles intended to come into contact with food*

* Inclusive subsequent amendments

In conjunction with following harmonized standards

EN 1186-1:2002; EN 1186-3:2002; EN 1122:2001; EN 13130-1:2004; EN14372:2004

Conditions of use:

- Type(s) of food intended to come into contact with the material:

Suitable for cold drinks

- Time and temperature and storage while in contact with food:

Time: maximum 2 hours

Temperature: 0°C – 40°C

- Ratio of food contact surface area to volume used: 6dm²/l

Substances, which are subject to "DUAL-USE" additives in materials or "PURITY CRITERIA".

- No dual use additives were used in the manufacture of this product

- There are no substances subject to purity criteria

Information about the compliance of substances used are subject to any restriction or specification

- This product is in compliance with overall and Specific Migration Limits (SML's) standard testing conditions laid down in Regulation (EU) 10/2011. Additional information including test reports can be provided on request.

Functional barrier

There is no function barrier present.

Signed for and on behalf of:

Ede (NL)

Place of issue

01-01-2026

Date of issue

R.M. Sillessen
General Manager
solo midocean